

OVS

Residential Wall Fan Heater



With Surface Mounting Box

Recessed



Features

Color

- Standard: white, almond.
- Optional (upcharge applicable): metallic silver, bronze, metallic charcoal, aluminum, semi-gloss black, sand.
- Custom colors available upon request.

Finish

- Standard: epoxy/polyester powder paint.

Voltage

- 120V, 208V, 240/208V, 1-phase.

Construction

- 20-gauge steel cabinet.
- 22-gauge steel front cover.
- High-limit temperature control with automatic reset.

Fan

- Quiet fan operating.
- 500W to 1000W; 40 cfm fan and 1250W to 2000W; 80 cfm fan.
- Factory-lubricated motor.

Heating element

- Durable tubular heating element with fins.
- Factory sealed element upon request.

Control

- Built-in thermostat available with a control knob or tamperproof.

Note: If an electronic thermostat is used, it must be compatible with forced-air heaters.

Installation

- Wall installation only.
- The air outlet should be installed at least 4 in. (102 mm) from flooring withstands temperature and 10 in. (254 mm) from linoleum flooring.
- Quick installation with recess box mounting holes.
- Large wiring compartment.
- May be recessed in 2 in. X 3 in. stud partitions.
- Surface mounting box available.
- Tight fit with V-shaped recess box.

Warranty

- 5-year warranty against defects.

Application

- Entrance way, kitchen, bathroom, family room, basement.

Four mounting positions available. Pictures showing front panel. Directional vane air flow.

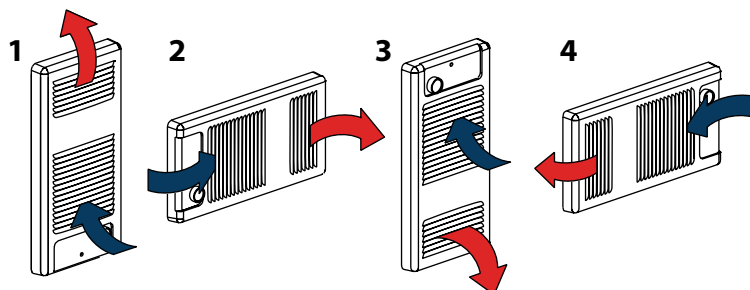

Models

Product #	Product # with Built-In Thermostat	Volts	Watts	Weight	
				lb	kg
OVSU0502	OVSU0502BL-TB6	120	500	9.0	4.1
OVSU0752	OVSU0752BL-TB6	120	750	9.0	4.1
OVSU1002	OVSU1002BL-TB6	120	1000	9.0	4.1
OVSU1252	OVSU1252BL-TB6	120	1250	9.0	4.1
OVSU1502	OVSU1502BL-TB6	120	1500	9.0	4.1
OVSU0500	OVSU0500BL-TB26	240/208	500/375	9.0	4.1
OVSU0750	OVSU0750BL-TB26	240/208	750/563	9.0	4.1
OVSU1000	OVSU1000BL-TB26	240/208	1000/750	9.0	4.1
OVSU1250	OVSU1250BL-TB26	240/208	1250/938	9.0	4.1
OVSU1500	OVSU1500BL-TB26	240/208	1500/1125	9.0	4.1
OVSU2000	OVSU2000BL-TB26	240/208	2000/1500	9.0	4.1
OVSU2008	OVSU2008BL-TB26	208	2000	9.0	4.1

Options

Product # Kit	Product # Factory installed*	Description
KIT-OVS-BS	-	Surface mounting box
KIT-OVS-DIS ¹	DIS ¹	Disconnect switch, 20A at 277V max. (120V, 208V, 240/208V only)
-	ES ²	Factory sealed element (120V, 208V, 240/208V only)
KIT-OVS-TB6	TB6	Single-pole bi-metal thermostat (347V factory installed only)
KIT-OVS-TB26 ³	TB26 ³	Double-pole bi-metal thermostat (347V factory installed only)
KIT-OVS-TB6-AV	TB6AV	Single-pole bi-metal tamperproof thermostat (347V factory installed only)
KIT-OVS-TB26-AV ³	TB26AV ³	Double-pole bi-metal tamperproof thermostat (347V factory installed only)

* For factory installed options, add the option number to the product number. See the **Product Code** section inside the front cover.

¹ For the U.S. only: The nominal current of the unit must not exceed 80% of the capacity of the disconnect.

² The option "sealed element" increases the reliability of these in humid environments. It does not completely eliminate the leakage currents of metal sheathed heating elements.

³ "Off" position.

Add "BL" for white, "AM" for almond.

Optional colors shown in the color chart section are available upon request.

